

MGF Edgesafe

MGF are committed to improving site safety in and around excavations through innovation. The “Shore-Safe” range of excavation safety systems bear testament to this commitment and are available for use with the complete range of MGF excavation support systems.

These systems are manufactured by MGF to meet the requirements of the Work at Height Regulations 2005, the Provision and Use of Work Equipment Regulations (PUWER) 1998 and BS EN 13374 (2004) Temporary Edge Protection Systems.

Edgesafe

MGF Edgesafe is a light weight steel edge protection system available in a variety of sizes with a range of fixing clamps allowing it to be used to provide perimeter edge protection to any excavations employing MGF excavation support systems.

The panels are manufactured from grade S235 hollow steelwork sections and plate with wire mesh infill panels. They are designed to be installed by two persons directly onto MGF excavation support systems using solid steel clamps with clamping bolts. The system satisfies the requirements of BS EN 13374 (2004) Class A Temporary Edge Protection Systems and is suitable for site use where the ground slopes up to a maximum of 10°. It is not suitable for use as a pedestrian barrier.

Product Notes

1. Ensure that the panels are not damaged and that the correct clamps are provided prior to use.
2. Always install the system from a position of safety. If working from an unsupported edge a full risk assessment should be carried out for the installation. Once clamped check each panel cannot be lifted, slide or rotate.
3. Always ensure that bolts are fully tightened and panels sit square and plumb with the upper rail at a minimum 1.0m above ground level.
4. Avoid gaps in the panels that are greater than 250mm.
5. Always replace damaged panels.
6. Edgesafe panels should only be fitted to MGF excavation support systems using the clamps specified. The customer must ensure that these support systems are installed in accordance with MGF guidelines and are sufficiently robust and stable to act as an effective edge protection support.
7. Take care when handling and storing on site as panels can be easily damaged. Always stack on timbers and lift either by hand or using a fork lift.
8. Do not use panels to support ladders, services, equipment or materials.



MGF Edgesafe

Connecting Clamps

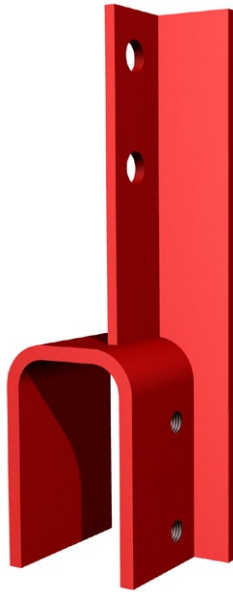

60 thick Panel Connector Clamp

Made from S275 steel profiles and designed to be used on all 60mm thick MGF boxes, the top 2 holes are used to connect the clamp to the edge safe panel, using M16 bolts c/w nuts and washers. The bottom 2 holes are tapped for M12 set screws, which are used as clamping bolts.

Product ID 4.317

Weight 3.0kg



110 thick Panel Connector Clamp

Made from S275 steel and designed to be used on all 100-110mm thick MGF boxes, the top 2 holes are used to connect the clamp to the edge safe panel, using M16 bolts c/w nuts and washers. The bottom 2 holes are tapped for M12 set screws, which are used as clamping bolts.

Product ID 4.316

Weight 3.5kg



16 thick Sheet Swivel Connector Clamp

Made from S275 steel profiles and designed to be used on all MGF Trench Sheets and Sheet Piles. The clamp comprises 2 parts, which are connected using a bolt, allowing 360° rotation to accommodate any misalignment in the sheets. The top 2 holes are used to connect the clamp to the edge safe panel, using M16 bolts c/w nuts and washers. The bottom 2 holes are tapped for M12 set screws, which are used as clamping bolts.

Product ID 4.318

Weight 2.6kg

MGF Edgesafe

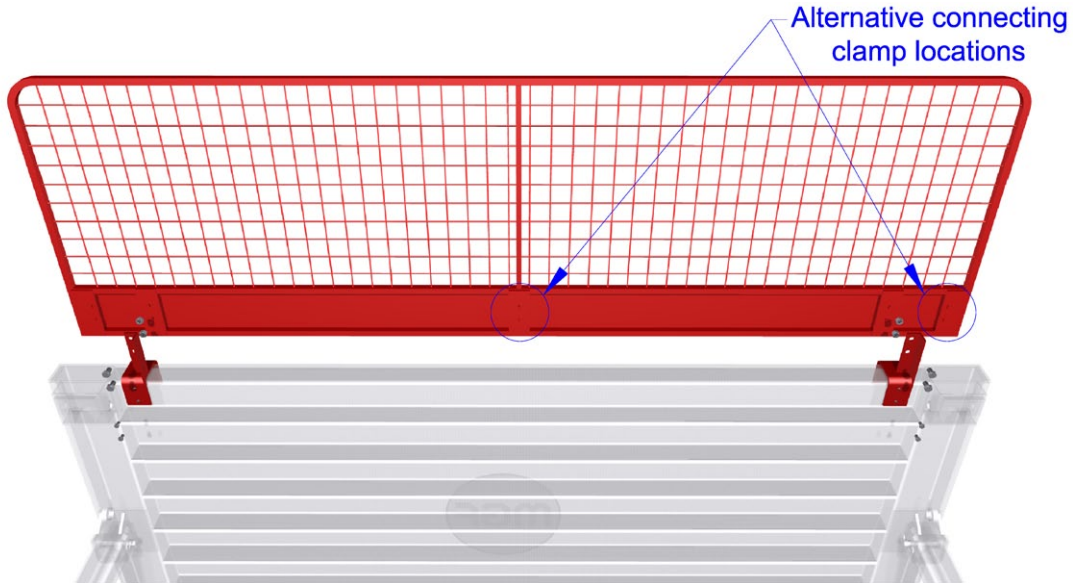

The clamps should be secured to the panel using 4 No. M16 bolts and nuts, the clamps then sit over the panel section or sheet and are clamped in place using 2 No. M12 set screws.

Desc.	Product ID	Weight* (kg)
500	4.319	8
1000	4.3195	13
2000	4.320	20
2500	4.325	25
3000	4.330	31
3500	4.335	38

* Panel only - excludes clamps

